

Model MV MINI V-ADAPTER

ELECTROMAGNETIC CHUCK CONTROLLERS
PERMANENT MAGNETIC CHUCKS
PERMANENT ELECTROMAGNETIC CHUCKS

An example of usage

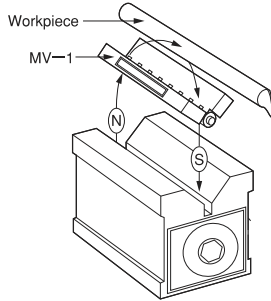

- Model: MV-1
- Dimensions: 80 × (42) × 10 mm
- Parallelism: 0.006
- Hardened

[Application]

This product itself is not magnetic, but when it is placed on a V-Holder having the N pole and S pole on separate sides like Model KVA, it induces magnetism to hold small diameter workpieces that can not be physically mounted directly. (See the figure below.) This adapter is recommended for holding workpieces during grinding, drilling and measurement.

[Features]

- The attractive faces can be set to any angle between 90 and 180 degrees.
- The hinge part acts as a separator to divide magnetic poles.

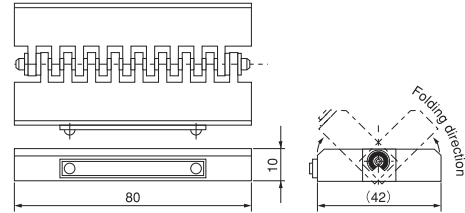

Model KMV MAGNETIC V-BLOCK

BLOCKS FOR MC
VACUUM CHUCKS
PROMELTA SYSTEM
SINE BAR CHUCKS
INJECTION MOLDING MACHINE MOLD FIXTURE

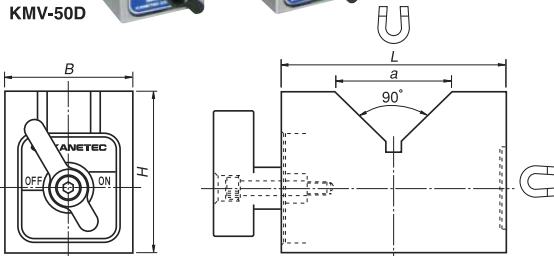

[Application]

Holding tools for round bar marking and drilling.
Holding tools for electric discharge machining.
Holding tools for three-dimensional measuring instruments and various measuring systems.

[Features]

- Workpieces can be held on the top face (V face), and rear face.
- T-handle ON/OFF switch comes attached, but can be removed.
- They are of dripproof and oilproof construction.
- One set consists of two blocks.
- Super high accuracy finish is also available. Please contact us.

Model	Holding Power	Applicable Diameter	Dimensions				Mass
			B	H	L	a	
KMV- 50D	150N (15kgf) or over	φ 50 (1.96)	40 (1.57)	50 (1.96)	70 (2.75)	36 (1.41)	1kg/2.2 lb×2
KMV- 80D	200N (20kgf) or over	φ 80 (3.14)	50 (1.96)	80 (3.14)	100 (3.93)	60 (2.36)	3kg/6.6 lb×2
KMV-125D	230N (23kgf) or over	φ 125 (4.92)	50 (1.96)	100 (3.93)	150 (5.90)	90 (3.54)	5kg/ 11 lb×2

※ The holding power applies to the V-face and φ 20 round bar. ※ For accuracy, see the table on page 51.

Model KMV-M MAGNETIC MINI V-BLOCK

WORKING TOOLS
MAGNETIC BLOCKS
MEASURING TOOL HOLDERS
MEASURING TOOLS

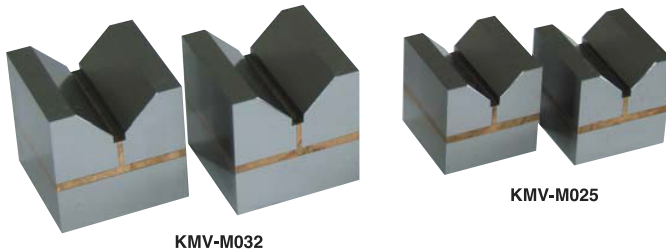

[Application]

These blocks are used to hold small diameter round bars on optical measuring equipment. (Non-waterproof type)

[Features]

- One set consists of two blocks. The attractive faces and other working faces have been machined accurately. The blocks can be turned ON and OFF by 90° turning using a screwdriver on the back.

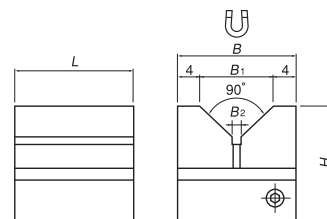

Model	Holding Power	Applicable Diameter	Dimensions					Mass
			B	B ₁	B ₂	H	L	
KMV-M020	9.8N (1kgf)	φ15 (0.59)	20 (0.78)	12 (0.47)	1.4 (0.05)	20 (0.78)	20 (0.78)	0.06kg/0.13 lb×2
KMV-M025	19.6N (2kgf)	φ20 (0.78)	25 (0.98)	15 (0.59)	2 (0.07)	25 (0.98)	25 (0.98)	0.13kg/0.28 lb×2
KMV-M032	49 N (5kgf)	φ25 (0.98)	32 (1.25)	20 (0.78)	1.6 (0.06)	32 (1.25)	32 (1.25)	0.24kg/0.53 lb×2

※ The holding power applies to round steel φ 10.

■ The dimensional accuracy of KMV is based on Kanetec's in-house standard. When you need higher accuracy, please contact us.